

L.E.S.S. IS MORE

Be Prepared in an Event of an Emergency

Annie Richardson Bass Building 2800 West Bowie Street

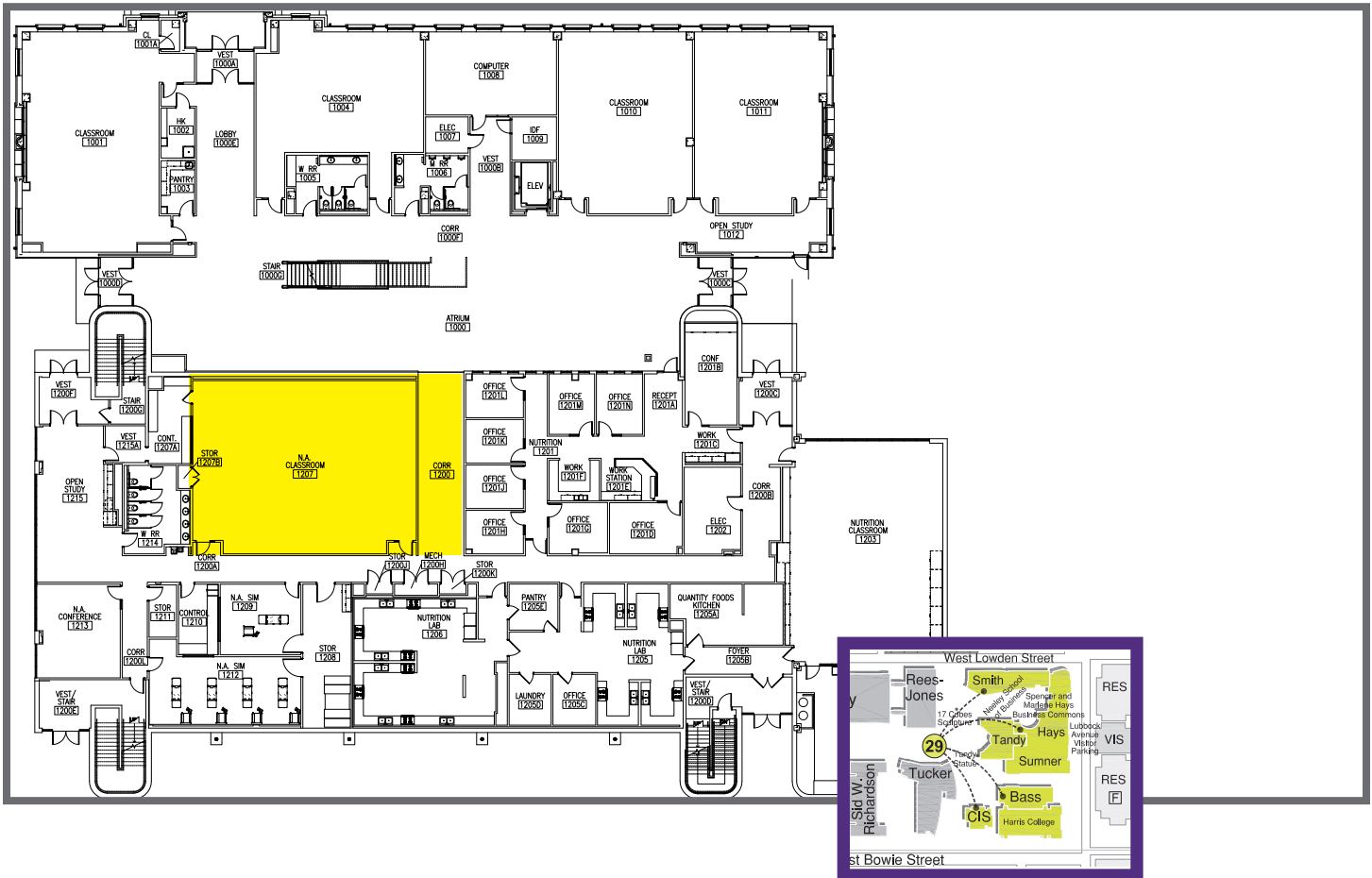

Run
If you are sure that you can get to safety.

Hide
If you are not sure where the shooter is.

Fight
As the last resort.



Quickly and safely leave the building using the nearest exit. Meet at the Rally Point.

Rally Point #29
Brick paved circle between Rees-Jones and Tucker



Quickly and safely relocate to the lowest level of the building. Stay away from exterior windows.

Seek Shelter Areas
1st floor corridor from rooms 1200 to 1207
First floor restrooms