

# L.E.S.S. IS MORE

*Be Prepared in an Event of an Emergency*

## Greek Village FA3 3532 Pond Drive

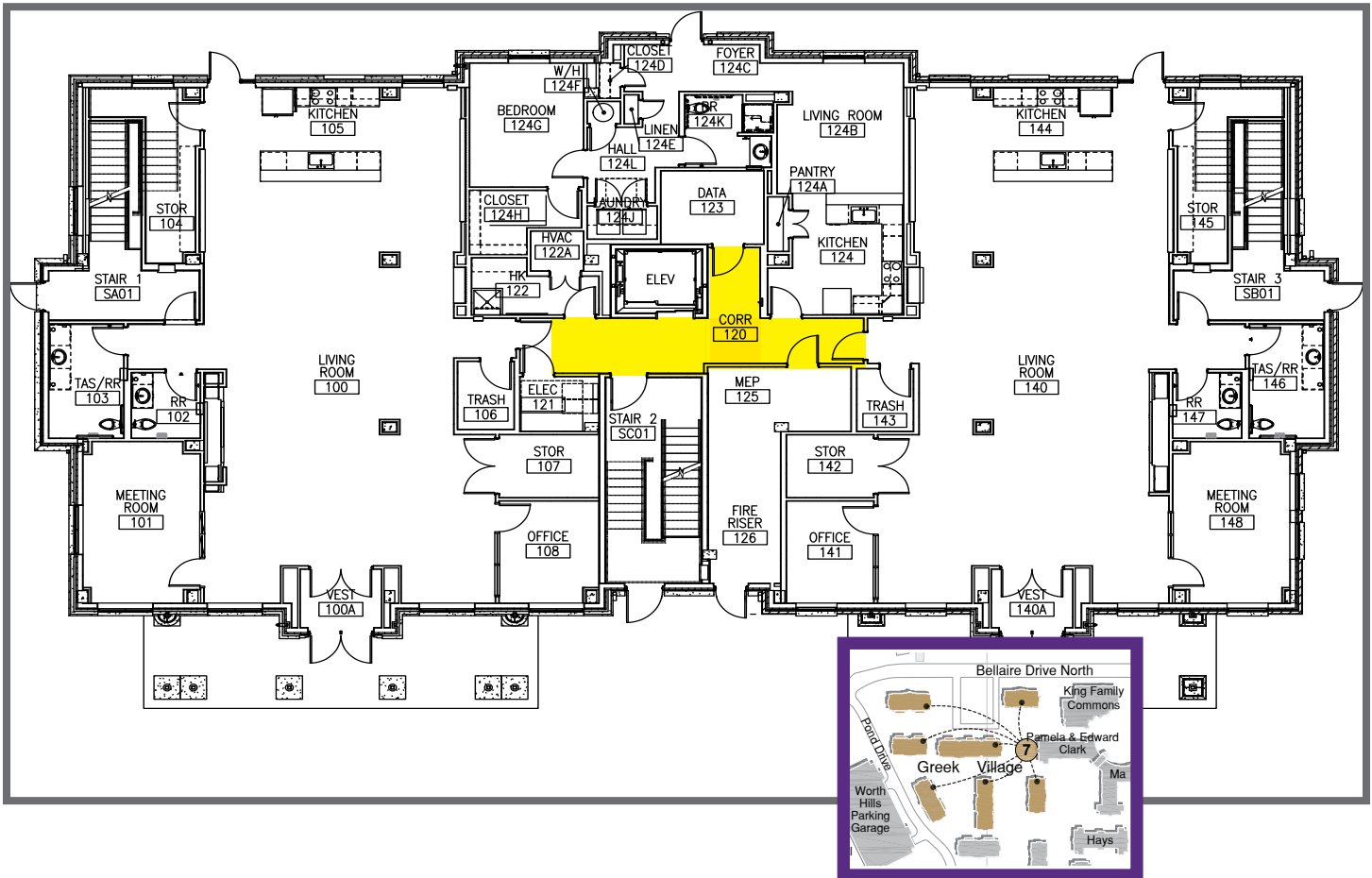

**Run**

If you are sure that you can get to safety.

**Hide**

If you are not sure where the shooter is.

**Fight**

As the last resort.



Quickly and safely leave the building using the nearest exit. Meet at the Rally Point.

 **Rally Point #7**  
Panhellenic Columns



Quickly and safely relocate to the lowest level of the building. Stay away from exterior windows.

 **Seek Shelter Areas**  
Ground Floor