

# L.E.S.S. IS MORE

*Be Prepared in an Event of an Emergency*

## Abell-Hanger House 2901 Sandage Avenue

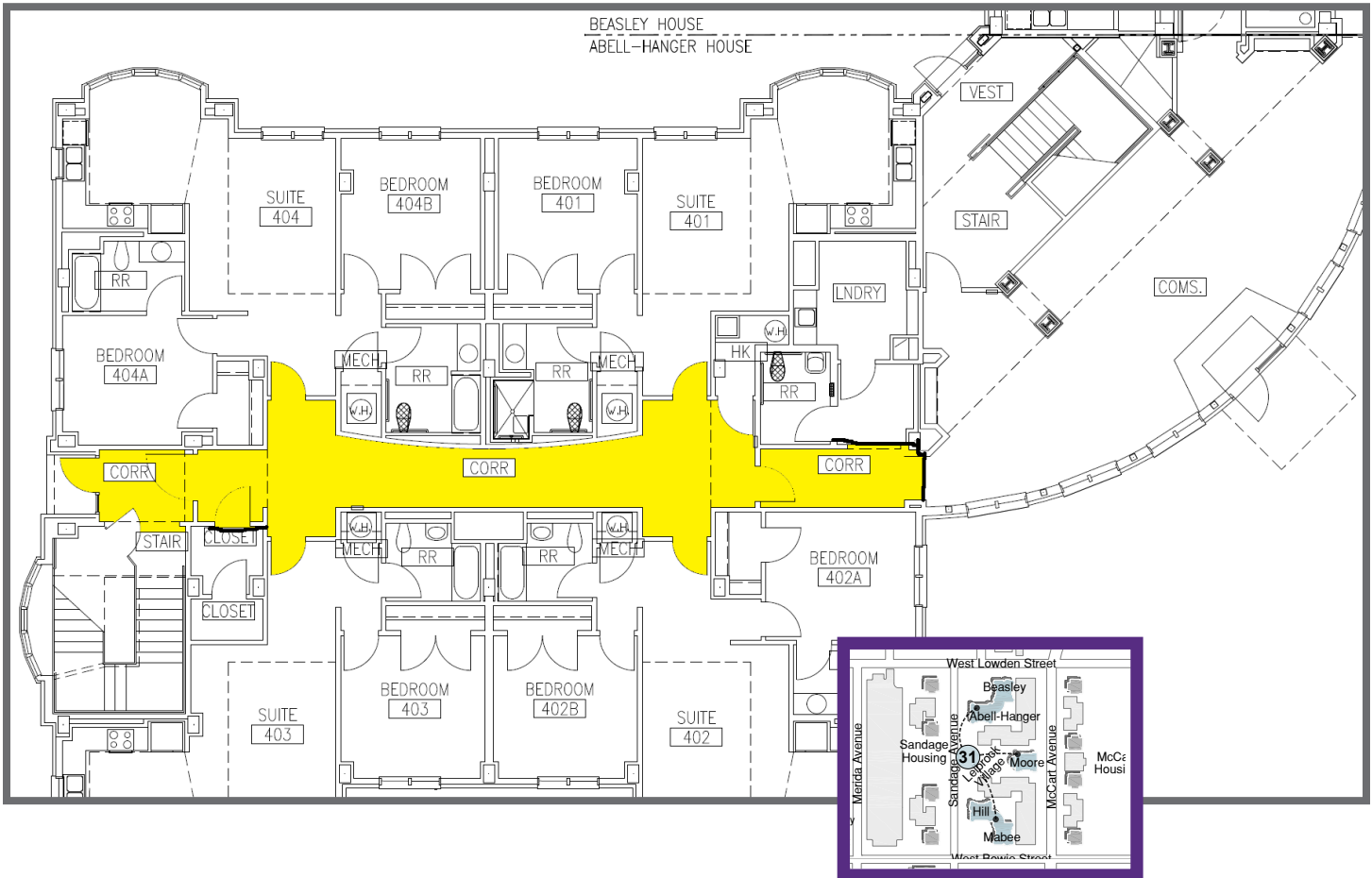

**Run**

If you are sure that you can get to safety.

**Hide**

If you are not sure where the shooter is.

**Fight**

As the last resort.



Quickly and safely leave the building using the nearest exit. Meet at the Rally Point.

**Rally Point #31**

Grass area on the north side of the Sandage Avenue entrance



Quickly and safely relocate to the lowest level of the building. Stay away from exterior windows.

**Seek Shelter Areas**  
1st floor corridor